





Mobile homes

-  Extra-Space
-  Sustainability
-  Energy Efficiency



Triinu is the smallest unit of our range but it still offers a useful sized kitchen/dining area with a bright and spacious living room. This mobile home is available as a single unit (one bedroom) or double unit (2 bedrooms). It's ideal as an extension to your family home and also as a studio/office or as a holiday retreat home.

Features:

- Open plan kitchen living room area
- Large windows
- Vaulted ceilings
- Optional terrace/decking

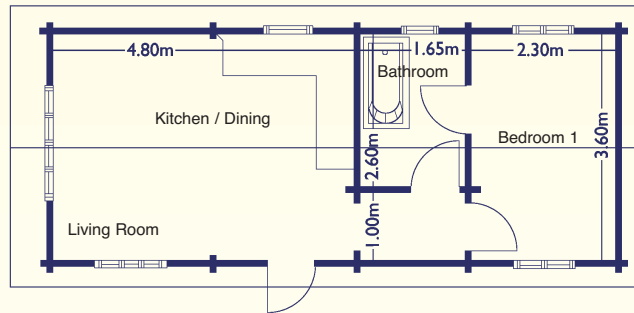

Triinu 1 — 9.14x3.80m (30x12ft) • 1 Bedrooms • 1 Bath • Total Area: 34.73m²

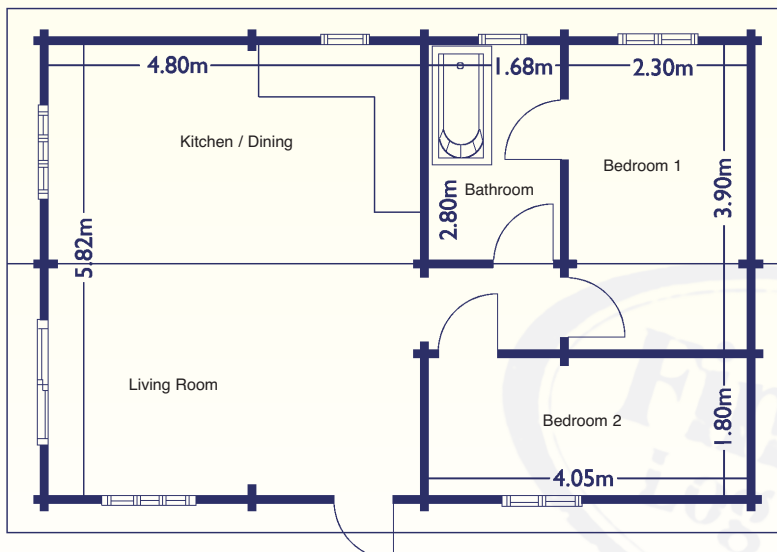

Triinu 2 — 9.14x6.00m (30x20ft) • 2 Bedrooms • 1 Bath • Total Area: 54.84m²

Suggested uses:

- Retreat Holiday Home
- Extra space for your home
- Visitors Accommodation
- Gym
- Office / Study room



Tiia



Tiia offers great space and is particularly suited to couples or small families. It features a wonderfully bright and spacious living accommodation with a good sized master bedroom and an extra one or two additional bedrooms.

Features:

- Open plan kitchen living room area
- Spacious bedrooms
- Large windows
- Vaulted ceilings
- Optional terrace/decking

Suggested uses:

- Small family Home
- Leisure Suite
- Office / Study room

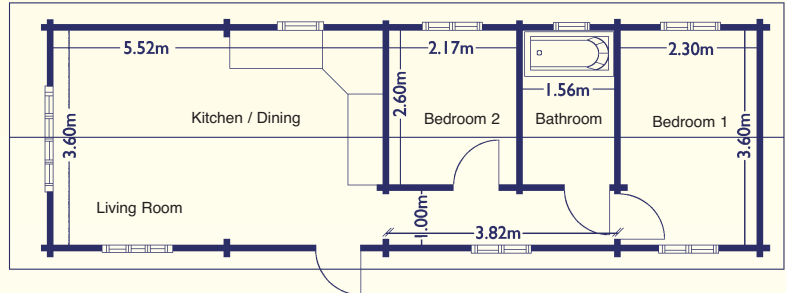

Tiia 1 — 12.00x3.80m (40x12ft) • 2 Bedrooms • 1 Bath • Total Area: 45.60m²

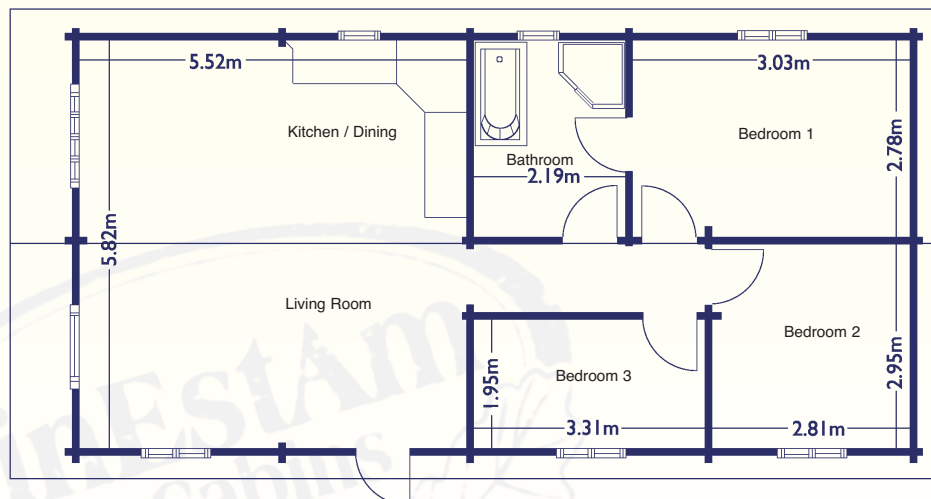

Tiia 2 — 12.00x6.00m (40x20ft) • 3 Bedrooms • 1 Bath • Total Area: 72.00m²

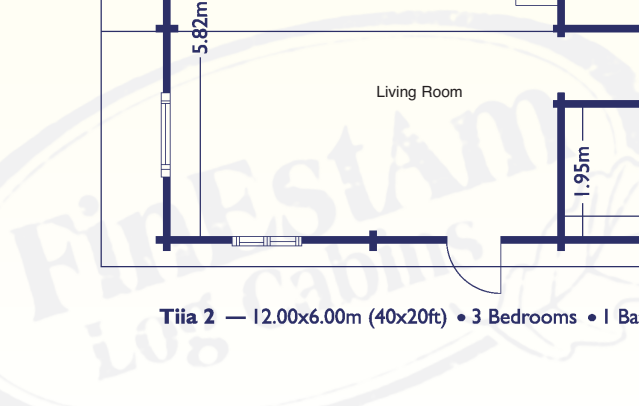

FinEstAm – Beautifully Comfortable

Cosy and comfortable, a superb living environment. It's healthier, energy efficient and you'll benefit from low running costs.





Jaak is probably our most versatile new design. It is a large unit with plenty of space, making it ideal for larger families, or groups. The Jaak offers a good sized kitchen area and the all important family friendly open plan living/dining area.

The Jaak 1 has three bedrooms and space for one family bathroom, whilst the Jaak 2 has room for four bedrooms and a second bathroom.

Features:

- Open plan kitchen living room area
- Spacious bedrooms
- Large windows
- Vaulted ceilings
- Optional terrace/decking

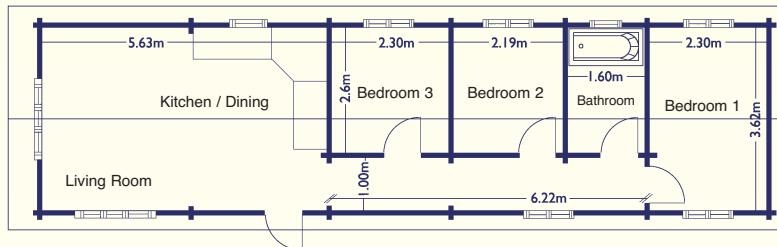

Jaak 1 — 14.50x3.80m (47x12ft) • 3 Bedrooms • 1 Bath • Total Area: 55.10m²

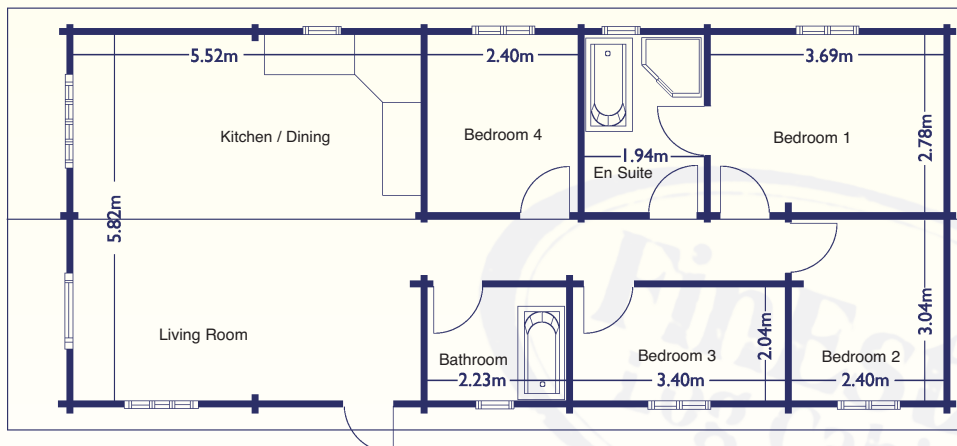

Jaak 2 — 14.00x6.00m (46x20ft) • 4 Bedrooms • 2 Bath • Total Area: 84.00m²



Anni



Anni is our largest and most luxurious cabin. It is ideal as a family home, park home or staff accommodation or office block. There is space for a fully integrated kitchen with a large dining area and a useful utility room.

The master bedroom benefits from its own en-suite bathroom, and additional space is provided for other four bedrooms and a second bathroom.

The Anni, just like all our other mobile homes, is available in two different sizes. Please see the layouts and compare the two to see what would suit you best.

Features:

- Spacious open plan kitchen living room area
- En-suite bathroom
- Good size bedrooms
- Large windows
- Vaulted ceilings
- Optional terrace/decking

Suggested uses:

- Family Home
- Park Home
- Staff accommodation

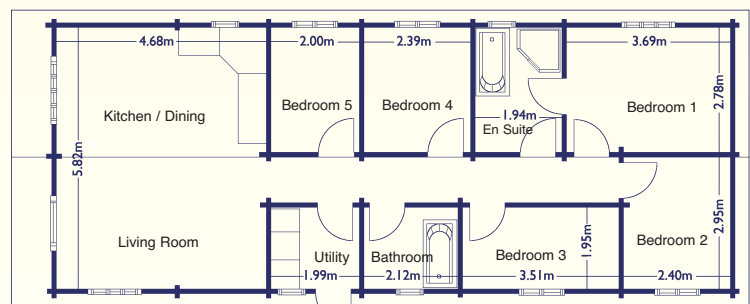

Anni 1 — 15.24x6m (50x20ft) • 5 Bedrooms • 2 Baths • Total Area: 91.44m²

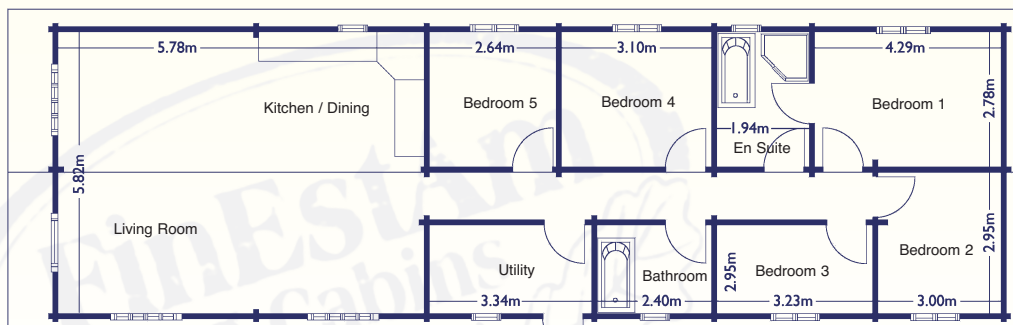

Anni 1 — 18.29x6m (60x20ft) • 5 Bedrooms • 2 Baths • Total Area: 109.74m²

FinEstAm – Environment

Our houses are eco- and environmentally friendly. All our timber is carefully selected and comes from sustainable sources.

Specifications for our Mobile Homes

Log mobile homes:

- Timber kits flat packed
- No access restrictions
- No high delivery costs
- Fully site built
- Rapid erection time
- Choice of models
- Fully customisable
- Pre built options

Walls

- 70mm triple tongue & groove interlocking logs (standard)
- Optional 90mm logs (available as an upgrade)
- Optional Winter pack (100-150mm stud framing for insulation covered with log cladding)
- Dwelling house specification (available as an upgrade)

Roof/ceiling

- 18x110 tongue & groove ceiling boards.
- Purlins 70x160 as standard (bigger sizes available)
- Rafters are 45x95 (standard)
- 45x195 rafters (available as an upgrade for dwelling house spec)
- Roof boarding is 18x110 tongue & groove or OSB boarding.
- Bitumen shingles as standard in green, red or charcoal black to choose from.

Floor

- Floor joists are 45x95mm (standard) and can also go up to 45x195 available as an upgrade
- 28x110mm tongue & groove floor boards
- Optional sub floor of 18mm OSB (an upgrade for a raft/strip of pile foundations)

Windows

- 50mm profile and 70mm frame double glazed turn & tilt open inwards
- Optional 58mm profile, 24mm double glazed windows
- Optional 68mm fully finished profile double glazed gas filled units (u-value 1.1)
- All the fittings are included as standard

Doors:

- External doors 2/3 double glazed, with an insulated bottom panel
- Internal pine panel doors

Timber frame options:

- All the models available in timber frame option
- Fully factory built on a steel chassis
- Plumbing, central heating and electrics included
- Kitchens and bathrooms fully built in
- Plug and play





About us

We are an Anglo-Estonian family run business with well established supply lines of factories, shippers and fitters for log cabins and homes, covering all of UK and delivering to anywhere in Europe.

Having built and lived in log buildings ourselves for many years gives us first hand experience of the comfort, warmth and wellbeing that is created from living in a log home. We have extensive knowledge and are passionate about the work we do offering you all the help, advice and information you will ever need.

We very much value customer satisfaction and are here to offer you the most comprehensive and professional service at all times. It is our aim to continue to provide high quality buildings and contribute towards an environmentally friendly lifestyle.

Our range of mobile homes has been developed to offer attractive designs in a wide variety of styles and accommodate different requirements. Now far from the basic caravans or cold park homes used in the early days, FinEstAm log built mobiles homes are becoming the choice of many. The high quality builds of FinEstAm homes and the spacious designs are able to accommodate anything you may have in mind. And what's more, these homes can also be fully customized. We really believe that by working together there will be something to keep you satisfied.

There are many advantages to living in a log home and these are just some:

- You will be living in a healthier environment
- Log homes are very energy efficient and environmentally friendly
- You will benefit from greatly reduced running costs
- Our mobile homes can either be static or mobile (on a steel chassis).

A further advantage is that the FinEstAm mobile homes are compliant with the British standards and caravan acts and are therefore free of VAT saving you thousands and allowing you to expand your budget.

Whether you are developing a leisure park, want a home for your family, need accommodation for your workers, need an office building or are thinking of a second property, a FinEstAm home could be your ideal solution.

Please feel free to browse our brochure and find the home that suits you best. You can also ring fax/email us your desired plans and we'll help you turn your ideas into a beautiful home.

If you want to order, have any questions or need more information simply give us a call on **0844 800 0308** and one of our friendly staff members will help you, alternatively visit our website at **www.finestamlogcabins.co.uk** for more answers and more designs.





SAUNAS &
GRILL HUTS



LOG CABINS



CHALETs &
LODGES



MOBILE HOMES



LOG HOMES

FinEstAm Ltd
Staple Cross Farm
7 Salisbury Road
Christchurch, Nr. Burton
Dorset BH23 7JG
Tel: 0844 800 0308 / Fax: 01 202 477 277
Email: info@finestamlogcabins.co.uk
Web: www.finestamlogcabins.co.uk